

# ASSEMBLY INSTRUCTIONS

## READ CAREFULLY

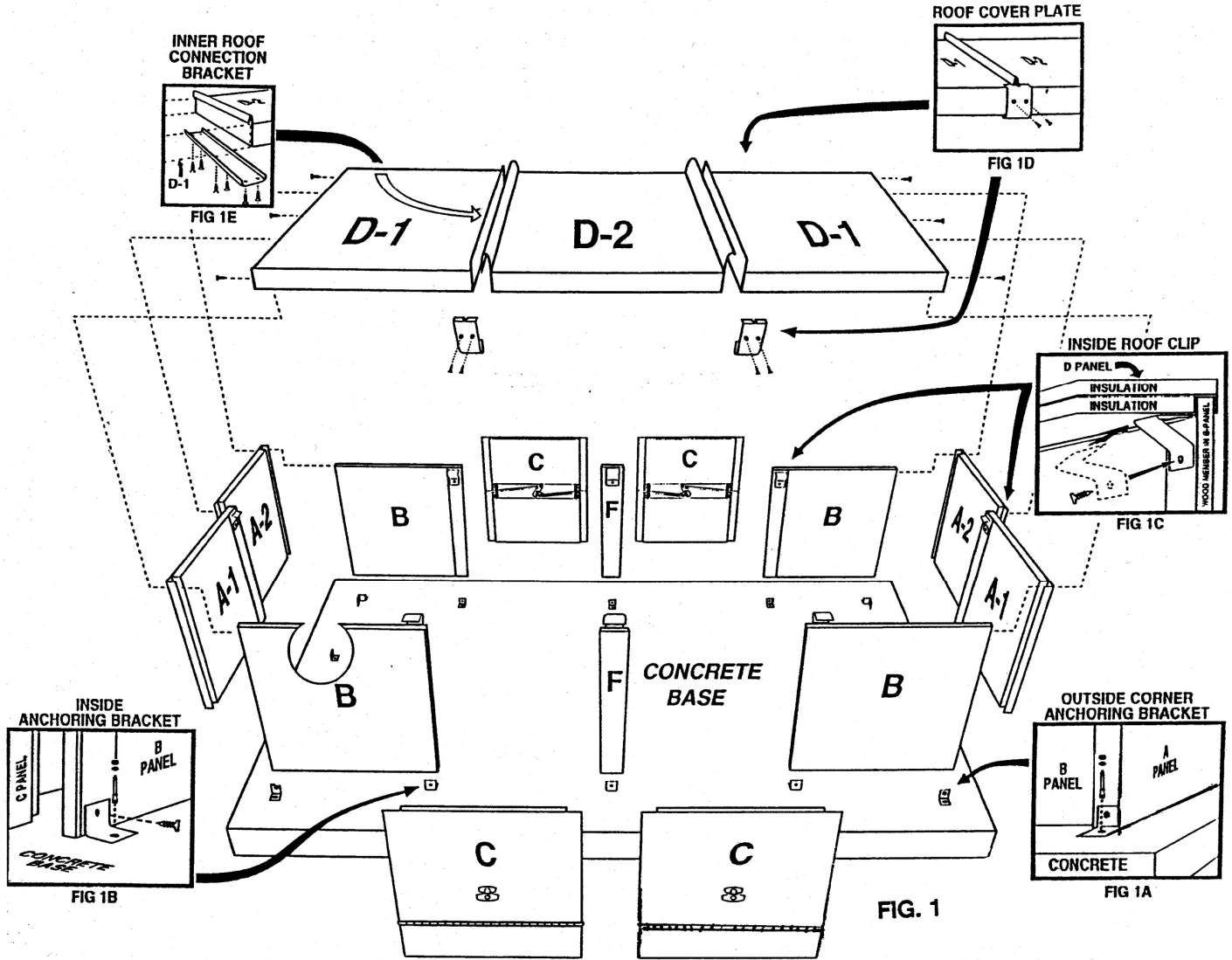

Model No.	Inside Dimensions	Outside Dimensions	Recommended Concrete Pad Dimensions
600TDS-Series	70"W x 128"L x 64"H.	73 3/4"W x 131 1/8"L x 67 1/4"H	84"W x 142"L x 6" thick
800DS-Seris	78"W x 150"L x 60"H	81 3/4"W x 153 1/8"L x 63 1/4"H	92"W x 164"L x 6" Thick
800TDS-Series	78"W x 150"L x 80"H	81 3/4"W x 153 1/8"L x 83 1/4"H	92"W x 164"L x 6" Thick

1. Center a 6" thick concrete base around installed BFP.
  - A. Place expansion material around riser pipe and place conduit for electrical power before placing concrete. **CONCRETE SHOULD BE FINISHED ABSOLUTELY LEVEL, FLAT AND SMOOTH.** Allow concrete to cure.
  - B. Mark concrete with outside dimensions of enclosure. Center enclosure around BFP.
  
2. Lay "A1 & A2" panels face down. Using three (3) hexhead screws fasten panels together thru holes provided on inside of panels. (Make sure panels are pulled close together before tightening screws). (For best results, insert a bead of silicone caulk into inside angle on "A1" panel.)
  - A. Using four (4) hexhead screws for each section assemble each "A-B" (end and side) section thru holes provided. Set on marked concrete base (FIG 2).
  
3. Set "D1" (roof) panel on "A-B" section. Using three (3) hexhead screws fasten "D1" (roof) to "A-B" section thru holes provided (FIG 1).
  - A. Using one (1) hexhead screw for each, install an **Inside Roof Clip** in the middle at the top *inside* of the "A" panel (end) and roof section. (FIG 1C).
  - B. Repeat 3 and 3A for other "D1" and "A-B" section.
  
4. Position "D2" (roof) middle panel between "D1"(roof) end panel and set in place. **"Temporarily"** place "F" (center) posts in position. On inside place an **Inner Roof Connection Bracket** over the two 2x4 connections of "D1" and "D2". Using hexhead screws provided, fasten **Inner Roof Connection Bracket** in place. (Fig 1E).

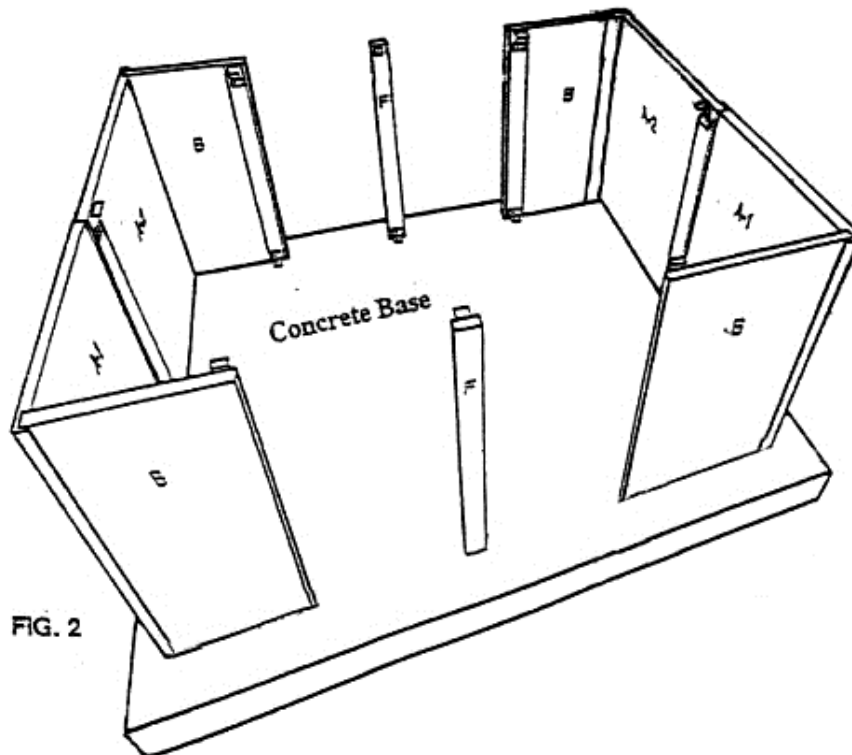

FIG. 2

**SAFE-T-COVER**  
**1-800-245-6333**  
**HCF600TDS-2**

5.
  - A. Using one (1) hexhead screw attach **Outside Corner SS Anchoring Brackets** to "A-B" sections. Using one (1) wedge anchor for each bracket fasten to concrete (FIG 1A). Use the masonry bit provided. Drill into the concrete 3" deep, insert wedge anchor, hit the wedge anchor until it is secure in the concrete. Use washer and nut provided to secure the anchor bracket. Fasten **Outside Corner SS Anchoring Brackets** at both corners on one side.
  - B. Using one (1) hexhead screw for each bracket attach **Inside Aluminum Anchoring Brackets** to "B" panels on the inside bottom at concrete. Using one (1) wedge anchor for each bracket fasten bracket to concrete (FIG 1B). Fasten **Inside Aluminum Anchoring Brackets** to both "B" panels and concrete on one side.
  - C. Insert **Inside Roof Clips** in "D1" (roof) panel at "B" panel. Using one (1) hexhead screw for each clip attach to "B" panel. (Fig 1C).
  - D. Using one (1) hexhead screw for each bracket attach **Inside Aluminum Anchoring Bracket** to "A" panel on inside at bottom. Using one (1) wedge anchor for each bracket attach bracket to concrete (Fig 1B).
6. Repeat Steps 5, 5A,5B, 5C and 5D on other side of enclosure.
7. Place "F" post in the center of the opening (Fig 2). Install **Inside Aluminum Anchoring Brackets** (Fig 1B) at bottom of "F" posts and **Inside Roof Clips** (Fig 1C) at top of "F" posts.
8. Using hexhead screws install **Roof Cover Plate (Fig 1D)** at "D1-D2" roof seams.
9. Set "C" panels and lock in place. (Solid "C" panel to be the **ACCESS DOOR PANEL**).
10. Provide ground-fault interrupter device in electrical circuit according to applicable codes. Install heater as per manufacturer's instructions and governing local and national codes.
11. For maximum protection it is suggested that the area between the bottom of the enclosure and the concrete base be caulked with the exception of the "C" panels. **DO NOT CAULK THE BOTTOM OF THE "C" DOOR PANELS.**

**REMOVE MASKING FILM IMMEDIATELY**  
**AFTER INSTALLATION**

SAFE-T-COVER  
1-800-245-6333  
HCF600TDS-3

## **CONTENTS**

**Model No. 600TDS-Series**

**Model No. 800DS-Series**

**Model No. 800TDS-Series**

- 2- "A1" (end) Panels**
- 2- "A2" (end) Panels**
- 4- "B" (side) Panels**
- 1- "C" (drain door) Panel**
- 3- "C" (solid access) Panel**
- 2- "D1" (roof ) Panels**
- 1- "D2" (roof) Panel**
- 2- "F" Panels**
- 4- Outside Corner SS Anchoring Brackets (2 1/2" x 2 1/2")**
- 8- Inside Aluminum Anchoring Brackets (3" x 3")**
- 8- Inside Roof Clips**
- 4- Roof Cover Plates**
- 2- Inner Roof Connection Brackets**
- 12- Wedge Anchors 3 3/4"**
- 66- Screws**
- 1- Magnetic Chuck**

## **TOOLS NEEDED**

**Hammer**

**Drill**

**9/16" Wrench**

**SAFE-T-COVER**

**1-800-245-6333**

**HCF600TDS-4**